

- NOTES**
- EXISTING STABLES
  - EXISTING DUNG STEAD  
407 CUBIC METER CAPACITY
  - EXISTING OPEN SAND ARENA
  - EXISTING SEWAGE TREATMENT PLANT
  - EXISTING PERCOLATION AREA
  - EXISTING ENTRANCE
  - EXISTING FEED STORE SILO
  - EXISTING BOUNDARY
  - EXISTING PADDOCK
  - EXISTING GALLOP
  - EXISTING WASH WATER TANK  
18 CUBIC METER CAPACITY
- LEGEND**
- EXISTING BUILDINGS FOR RETENTION
  - EXISTING BUILDINGS
  - EXISTING CONCRETE APRON
  - EXISTING HARDCORE AREA
  - EXISTING SURFACE WATER LINE
  - EXISTING PLANTING
  - EXISTING PLANTING

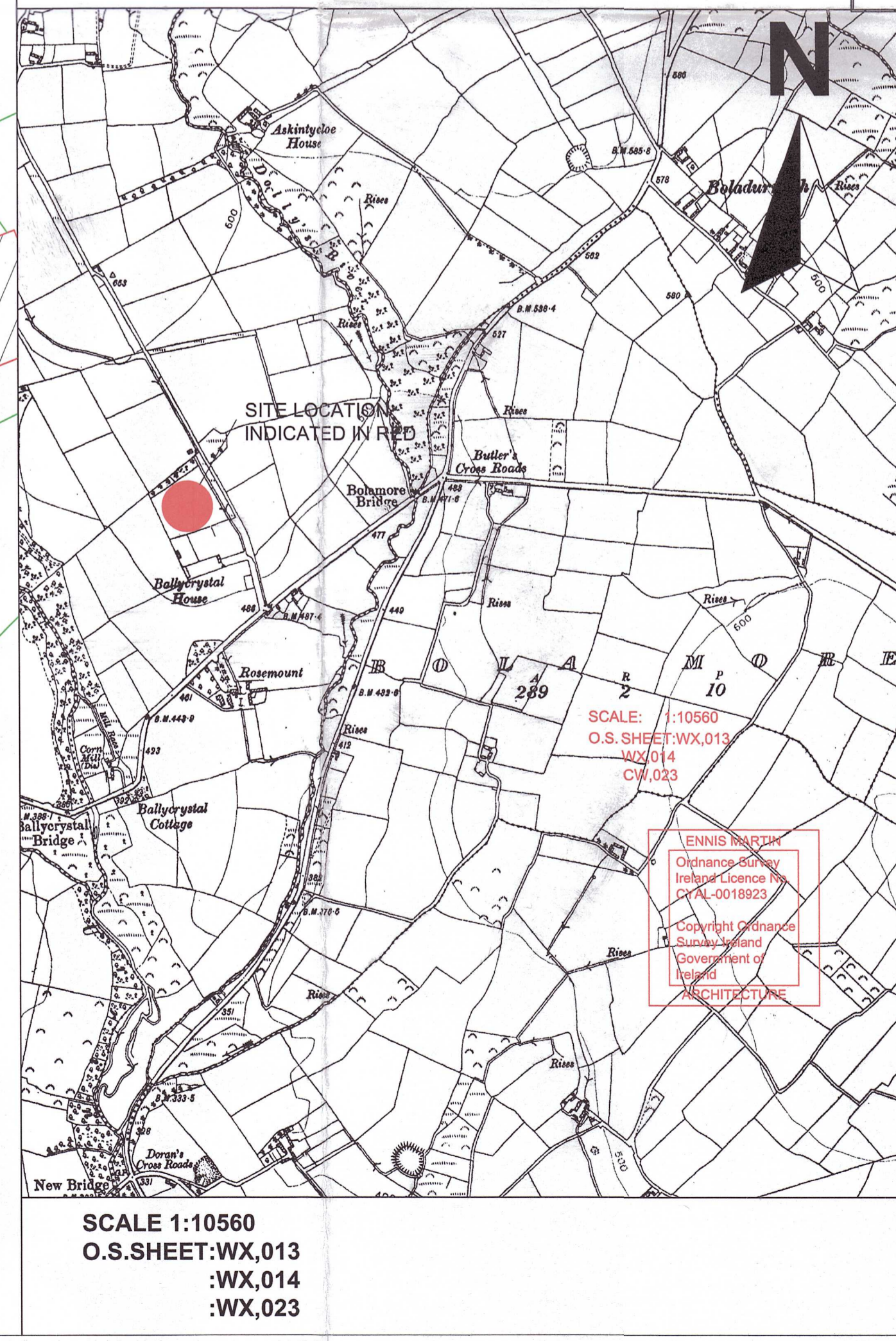

**AN BORD PLEANÁLA**

09 APR 2024  
LTR DATED FROM Application  
LDG:  
ABP: 319539

WEXFORD COUNTY COUNCIL  
RECEIVED  
15 NOV 2023  
PLANNING SECTION

**20231371**

**AN BORD PLEANÁLA**

28 MAR 2024  
LTR DATED FROM  
LDG:  
ABP:

SITE AREA: C. 1.98 HECTARES (C. 2.471 ACRES)

**ENNIS MARTIN**  
ARCHITECTURE design & planning consultants

Main Street, Ferns, Co. Wexford  
Tel: 053-9366779 Fax: 053-9367585  
Email: ennis martin arch@gmail.com

CLIENT: Cashwood Poles Limited

TITLE: Permission for retention of existing stables with ancillary services, including, open sand arena, horse walker, dungstead, feed store silo, staff canteen, toilets and sewage facilities at Ballycrystal, E.D. Rosard Co. Wexford

SCALE: 1:500 @ A1	SHEET NO: 1
DRAWING NO: PD 230002	JOB NO: -
DATE: JAN 2023	DRAWN BY: B.D.

**SITE LAYOUT MAP**